



Obelisk Rise

Kingsthorpe, Northampton

oriordanbond
SALES & LETTINGS



Obelisk Rise

Kingsthorpe
NN2 8TW

PRICE £278,000

A well presented three bedroom detached property, located in this desirable area of Kingsthorpe, within walking distance to local schools and amenities.

The accommodation comprises entrance porch, sitting room open to dining room with stairs to the first floor, kitchen. three well proportioned first floor bedrooms and a family bathroom. Outside to the rear is an enclosed garden with lawn and patio areas. To the front is a block paved driveway providing off road parking for two vehicles leading to a single garage. Further benefits include uPVC double glazing and gas radiator heating. (A/806/M)

Additional information

- Council Tax Band: C
- Energy Efficiency Rating: C

Viewing

Viewing strictly by appointment – details below

Disclaimer

O'Riordan Bond Estate Agents Limited has not tested apparatus, equipment, fittings or services and so cannot verify they are in working order. The buyer is advised to obtain verification from their solicitor or surveyor.

O'Riordan Bond Kingsthorpe Sales
01604 722007

kingsthorpe@oriordanbond.co.uk

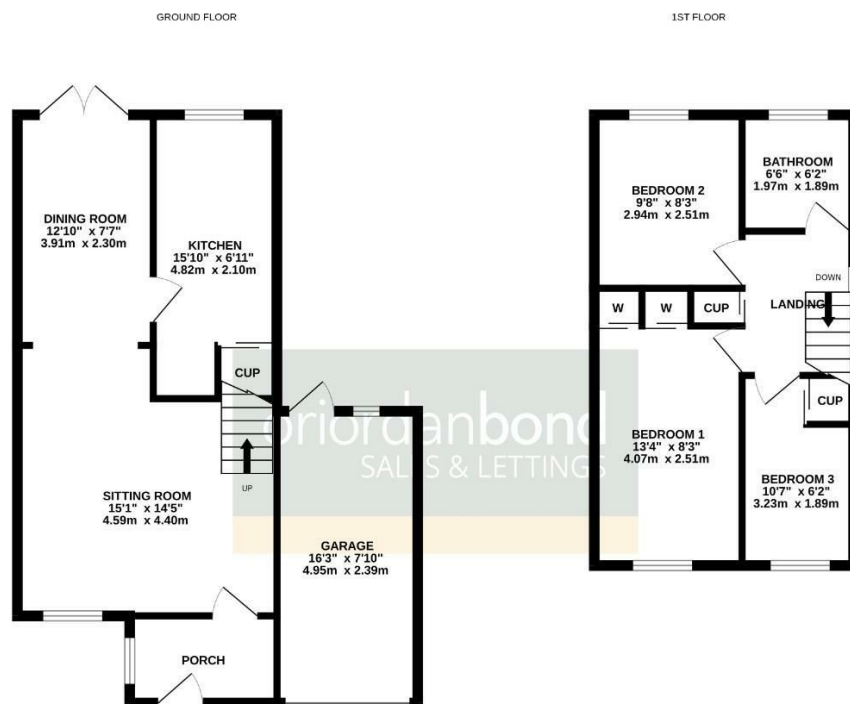

SQ FTG DOES NOT INCLUDE GARAGE
TOTAL FLOOR AREA: 806sq.ft. (74.9 sq.m.) approx.
Whilst every attempt has been made to ensure the accuracy of the floorplan contained here, measurements of doors, windows, rooms and any other items are approximate and no responsibility is taken for any error, omission or mis-statement. This plan is for illustrative purposes only and should be used as such by any prospective purchaser. The services, systems and appliances shown have not been tested and no guarantee as to their capability or efficiency can be given.
Made with: Merge 2025

